

Rumbleplace - Box & Grill

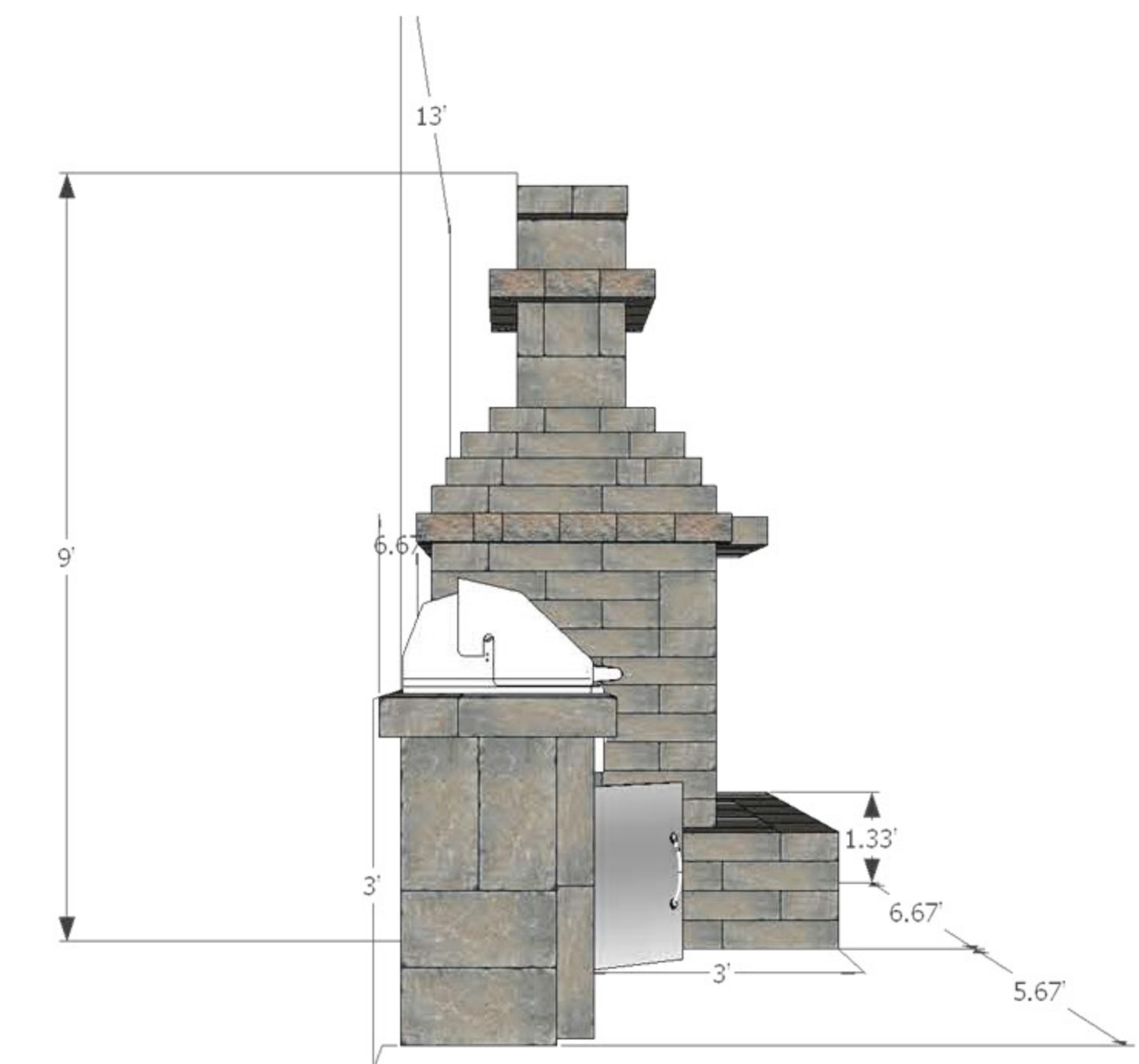

GeoStone Retaining Walls
Various Wall Profile
P.O. Box 325
Westover, AL 35185
Tel: 205-678-9969
Toll Free: 877-GEO-9900
<http://geostone.com>

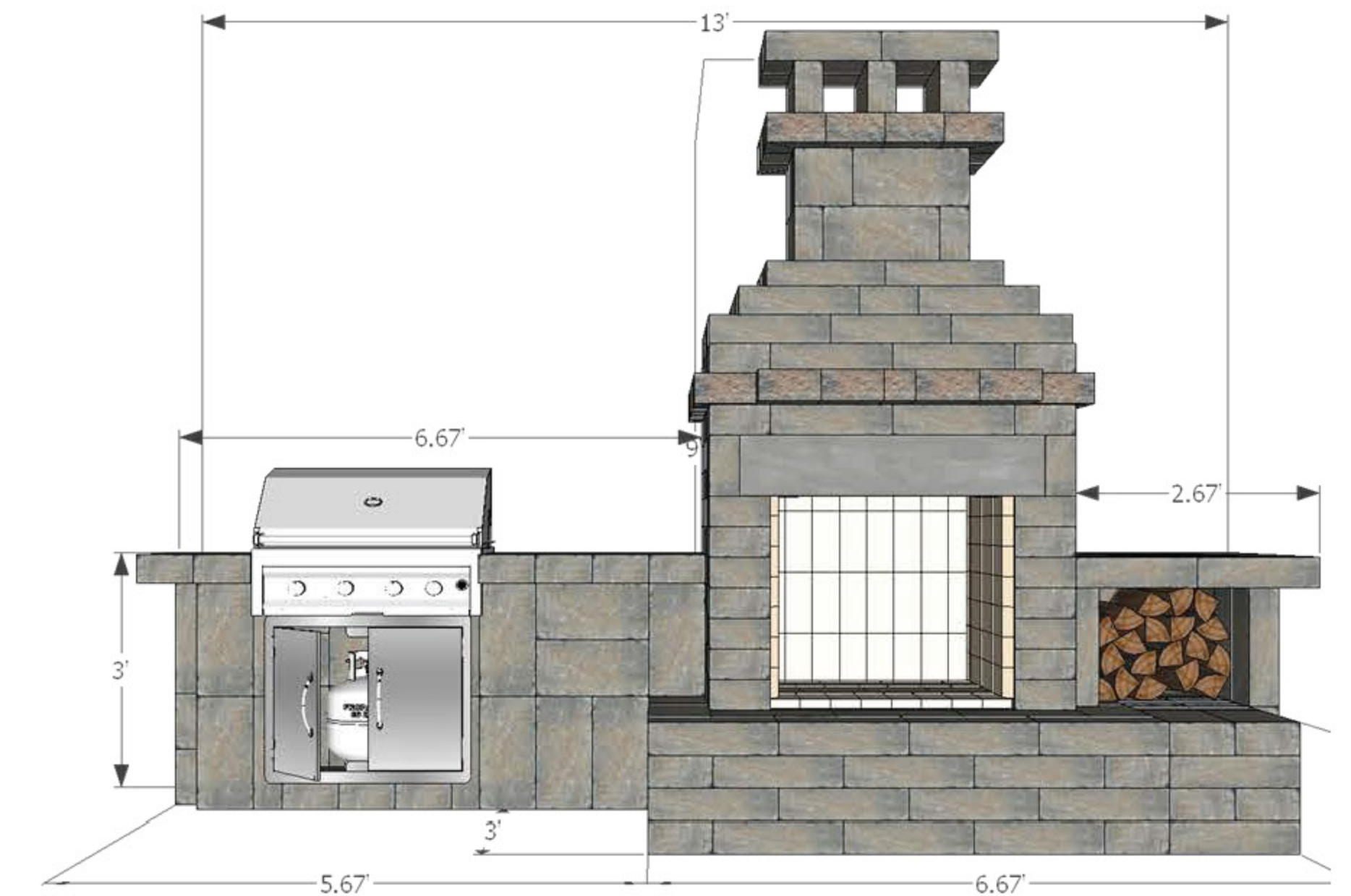

DESCRIPTION
The structures in this drawing are for illustration purposes only and were designed according to industry standards and procedures. Certain factors such as drainage, soils, surcharge, etc. will effect the overall design of the wall. It is recommended that all drawings be verified by a professional engineer before applying to actual situations.

GEOSTONE[®]

RETAINING WALL SYSTEMS

P.O. BOX 325 - WESTOVER, AL 35185 • 205-678-9969
WWW.GEOSTONE.COM

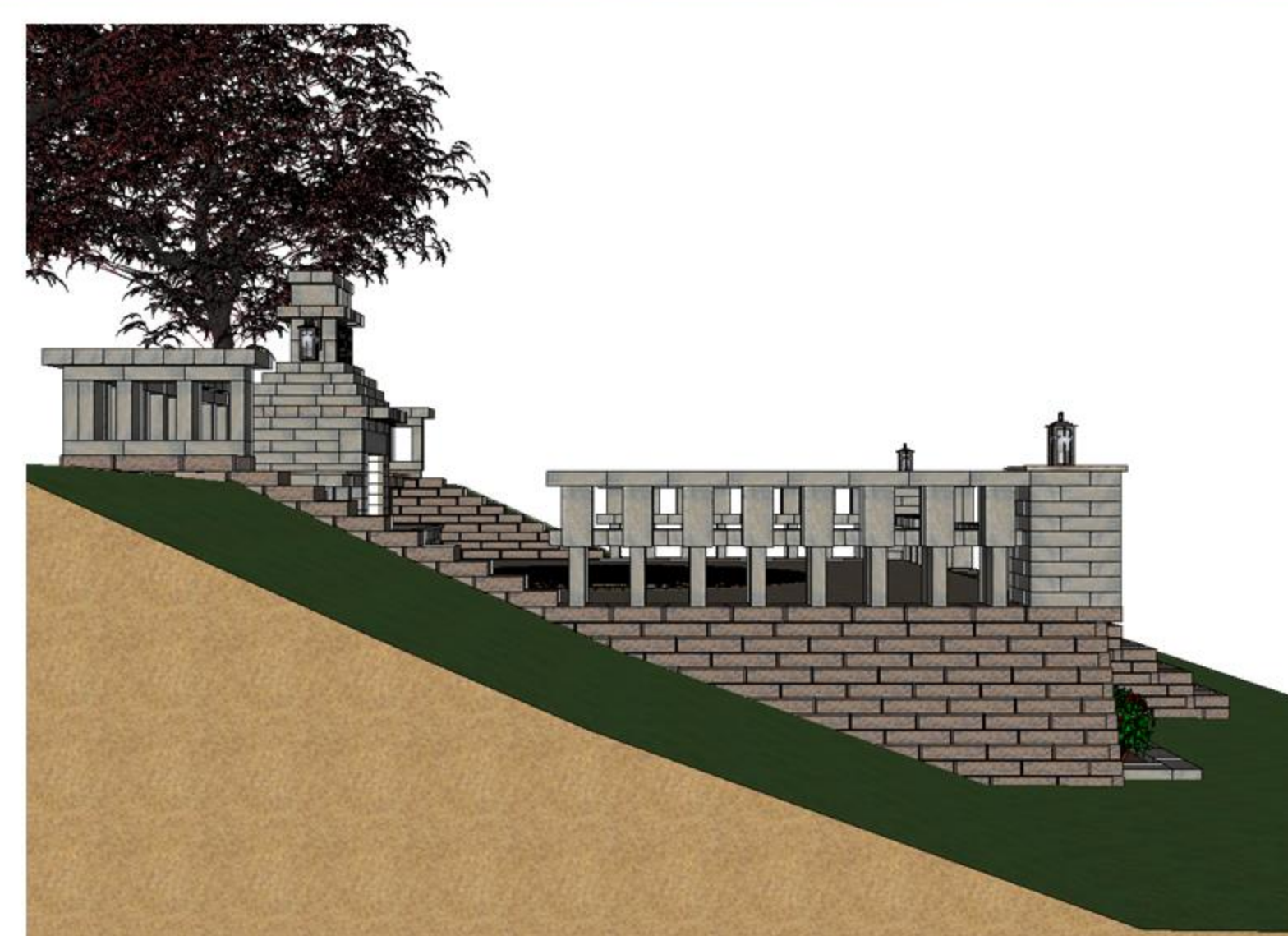

One of latest concept drawings. This one is for people with what would be considered unusable slopes in their back yards. You want a patio or entertainment area but the slope will not allow it. Wooden decks cannot support heavy structures plus they don't give the look and feel of hardscapes. This concept takes the soil cut out of the slope and uses GeoStone retaining walls to create a large level surface to put a patio, pool, outdoor fireplace, and/or outdoor kitchen. A majority of the fill material for this structure could potentially come from the slope which would significantly reduce the cost of this project. A great option for those who have unusable property due to sloping topography.

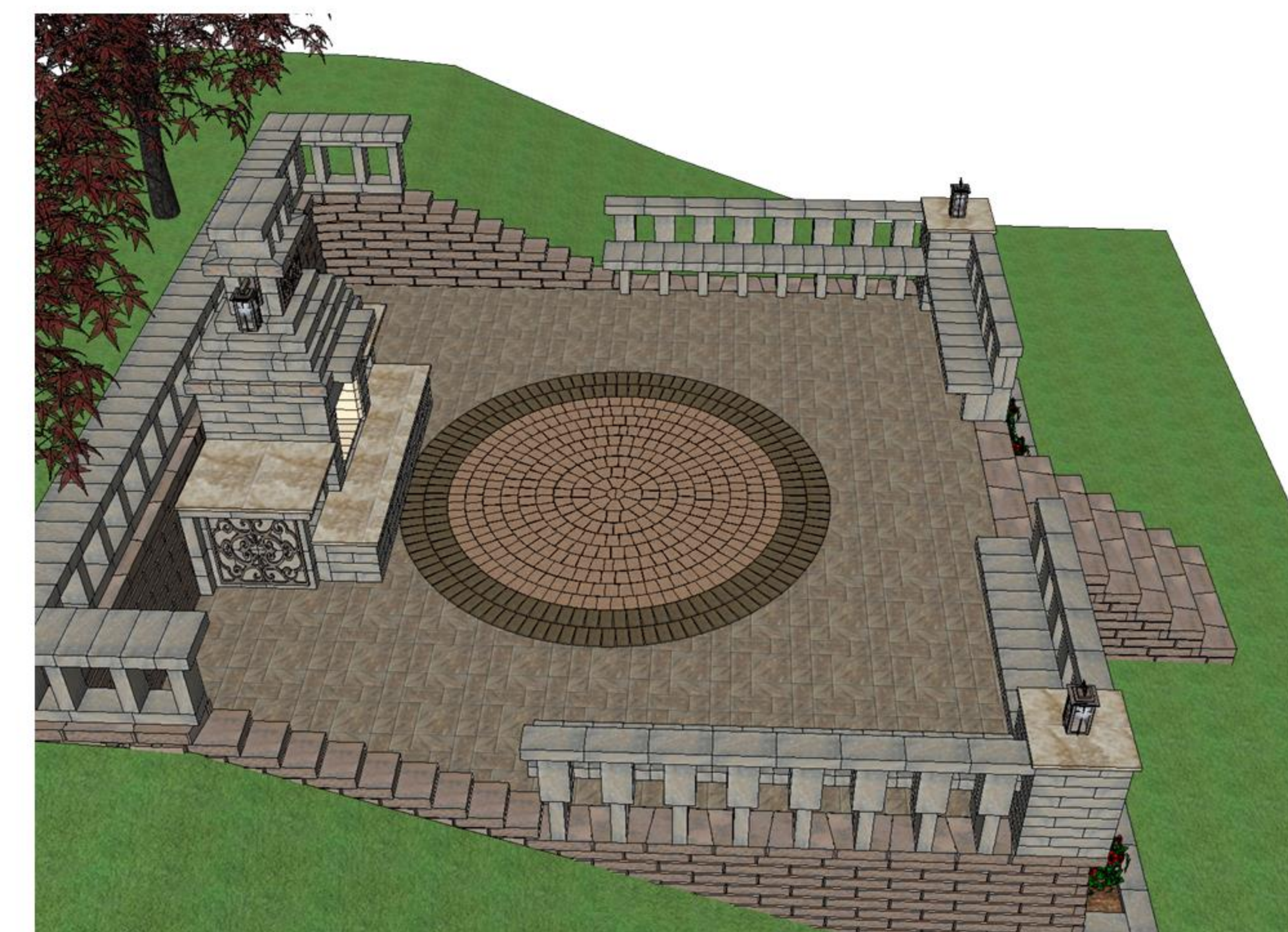

Top View

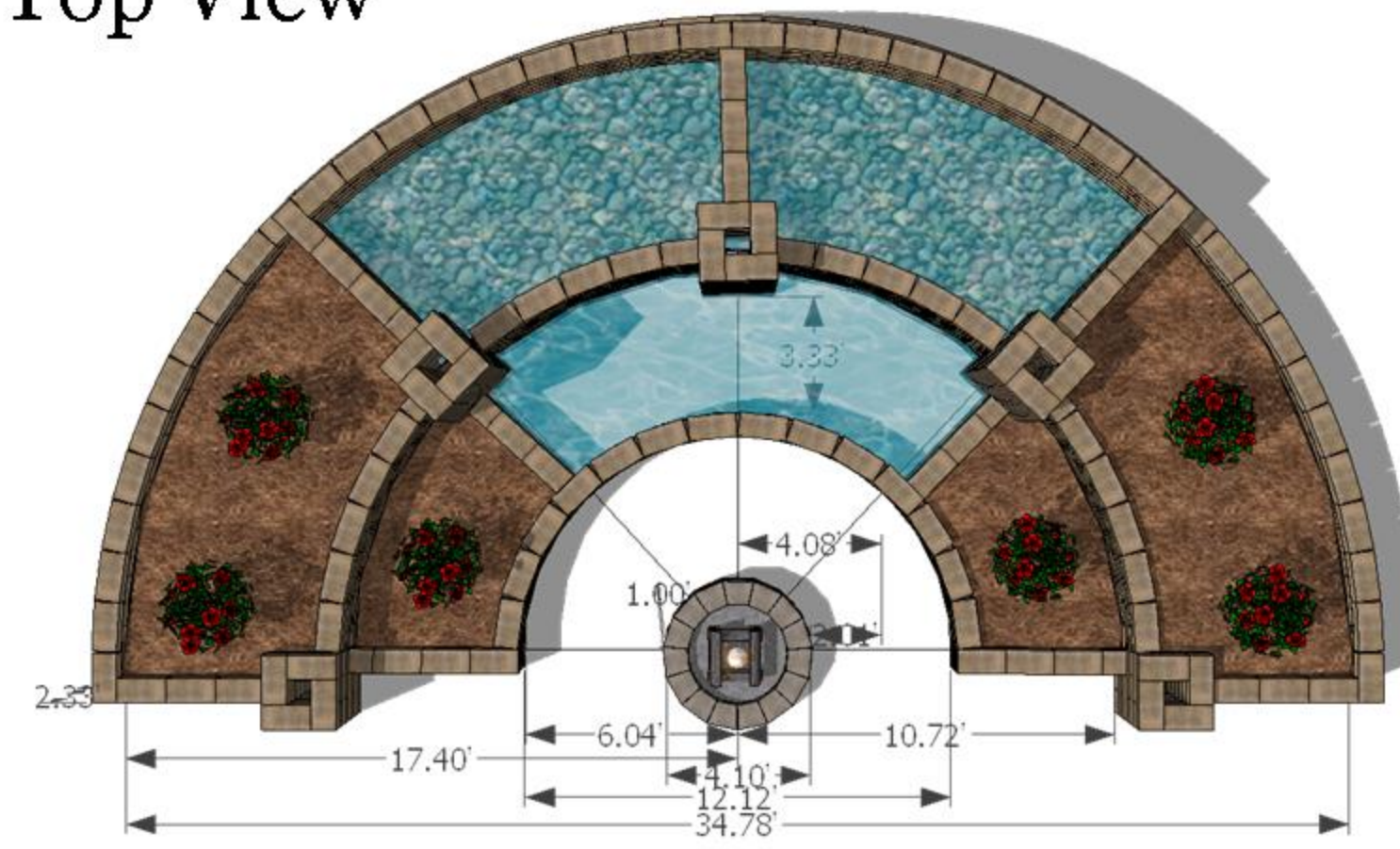

Front View

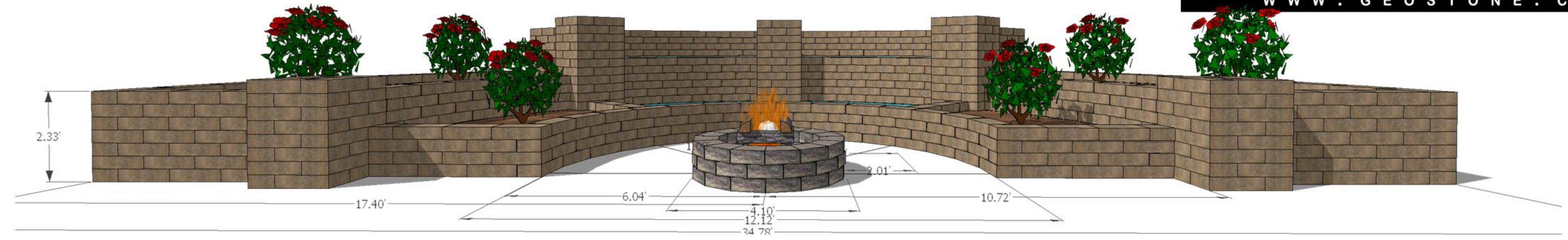

Isometric View









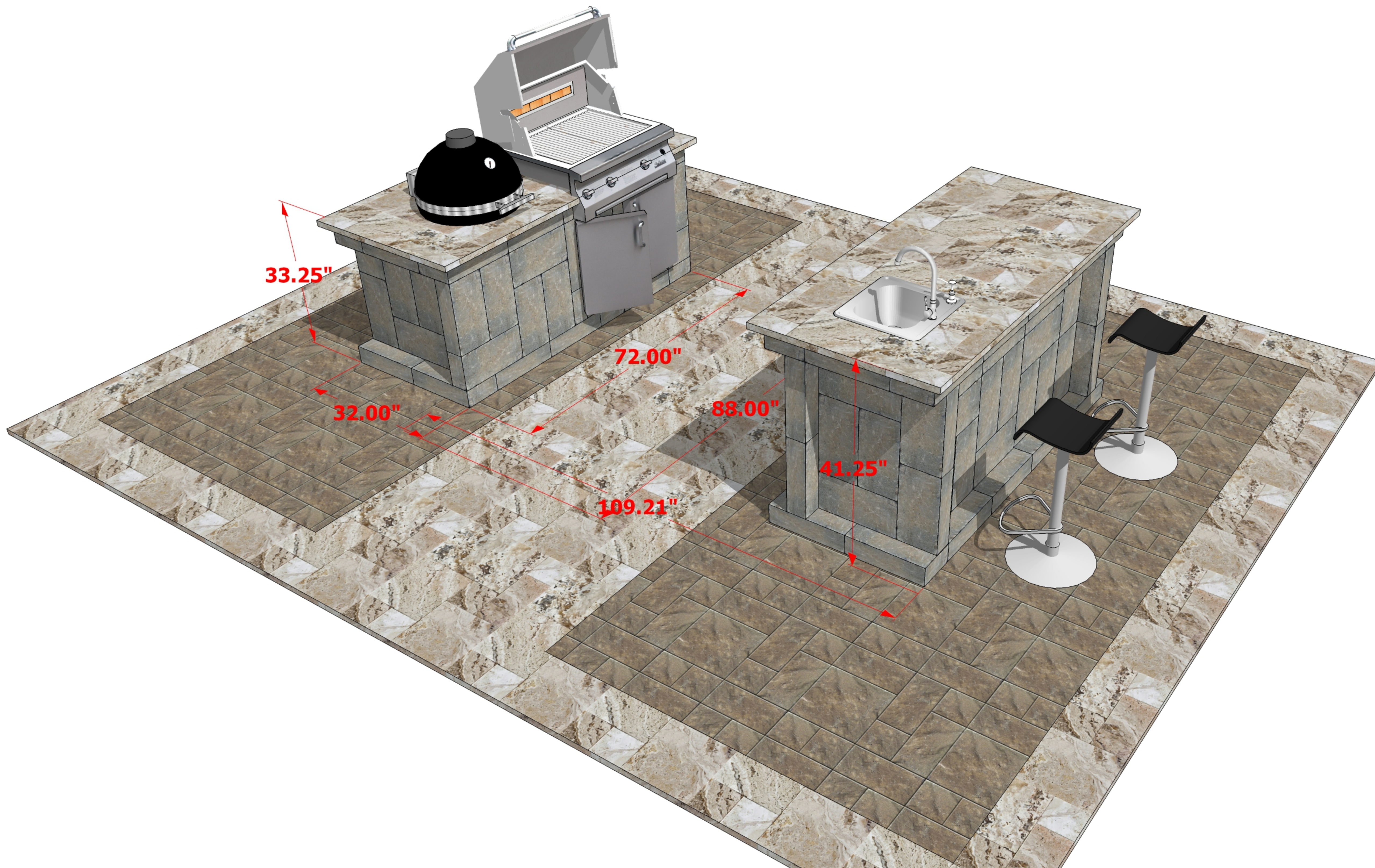

33.25"

32.00"

72.00"

88.00"

41.25"

109.21"

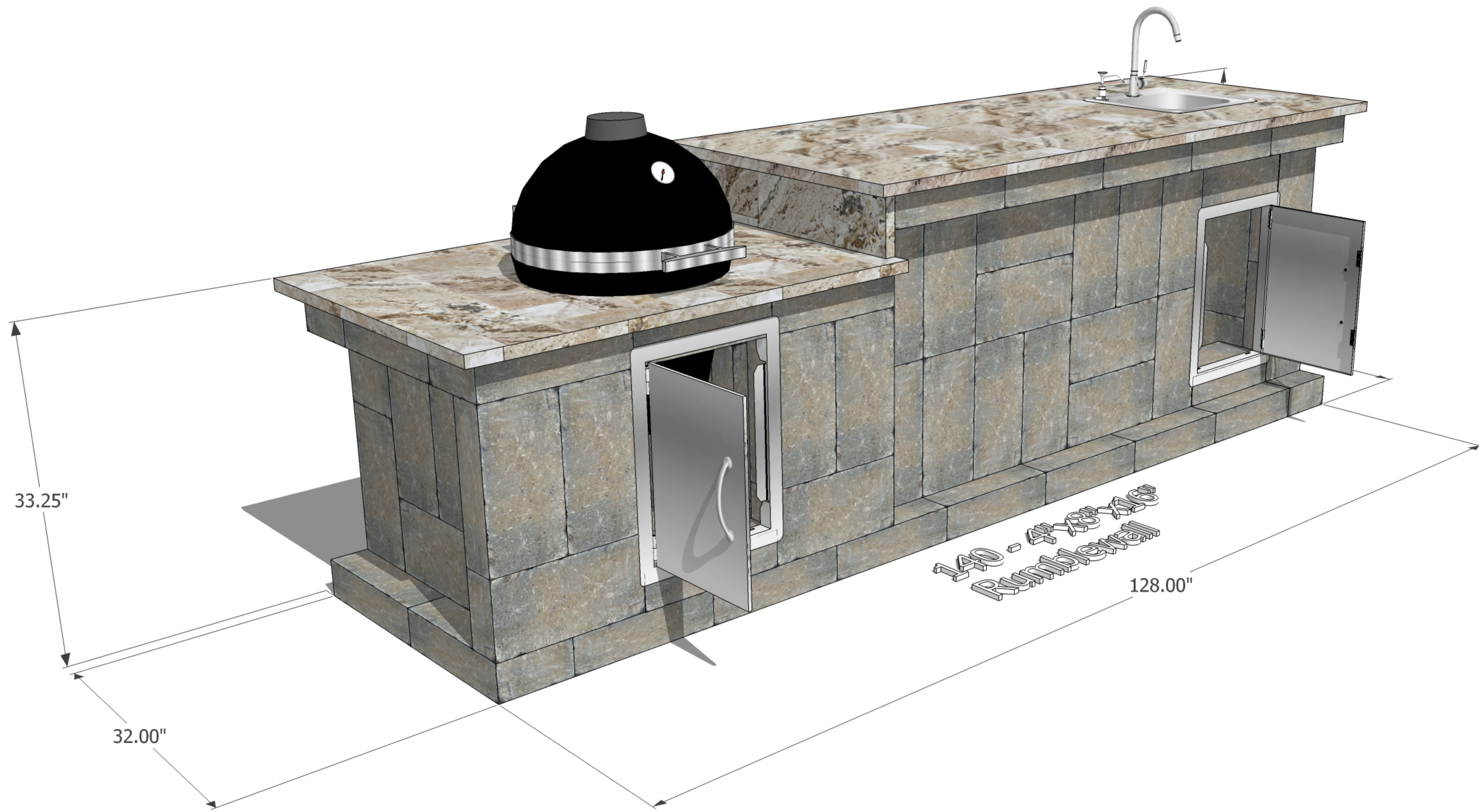

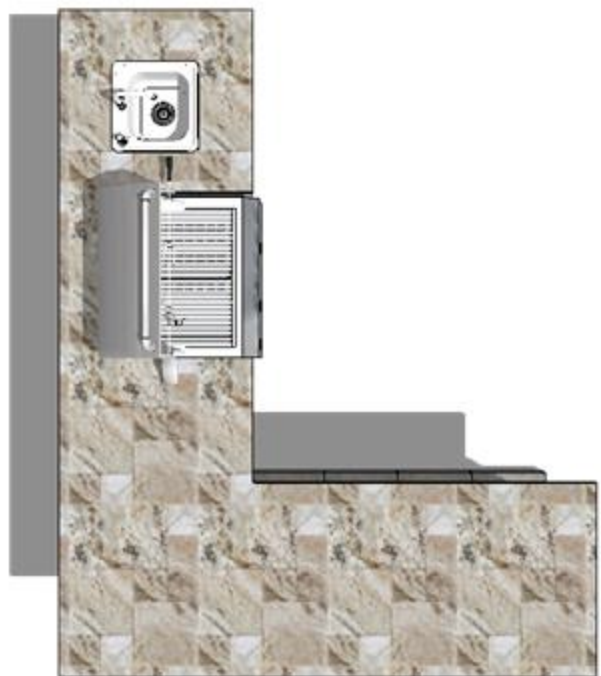
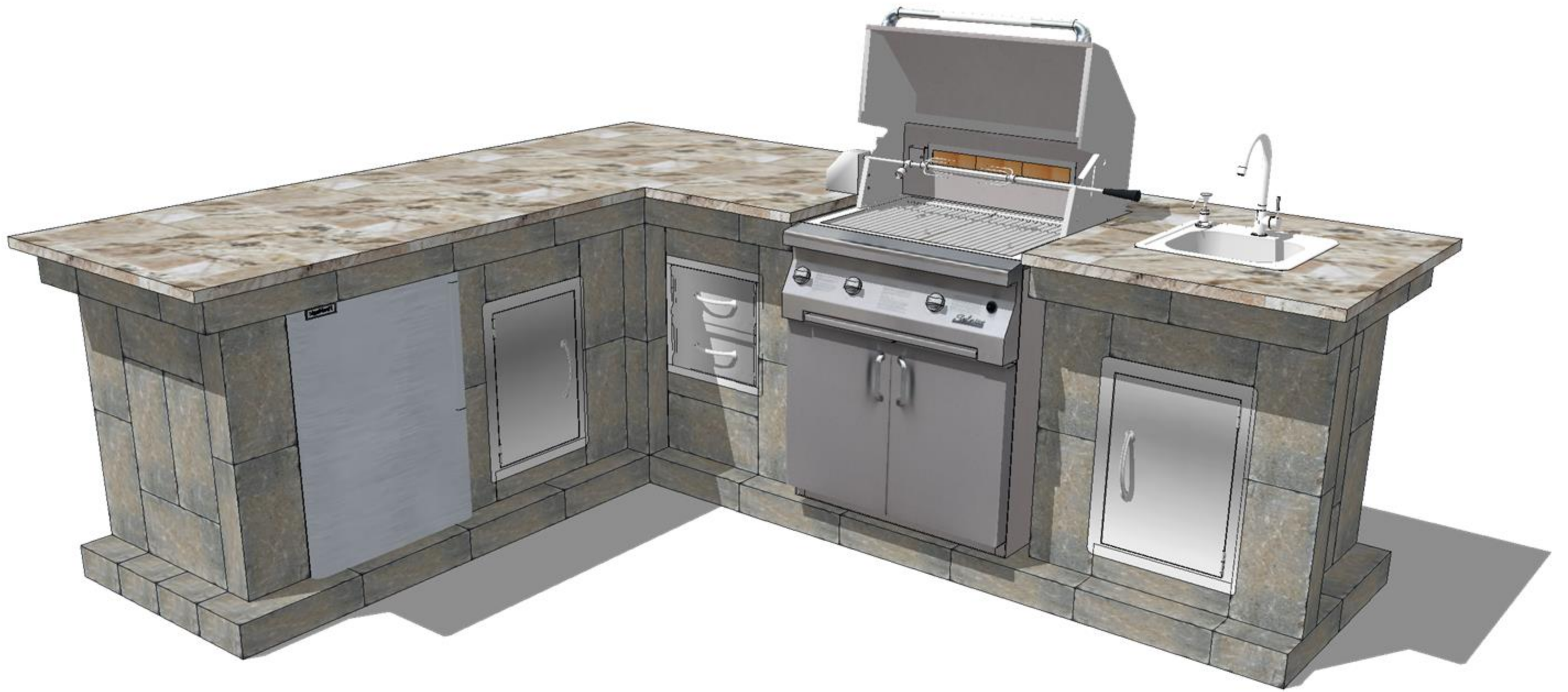



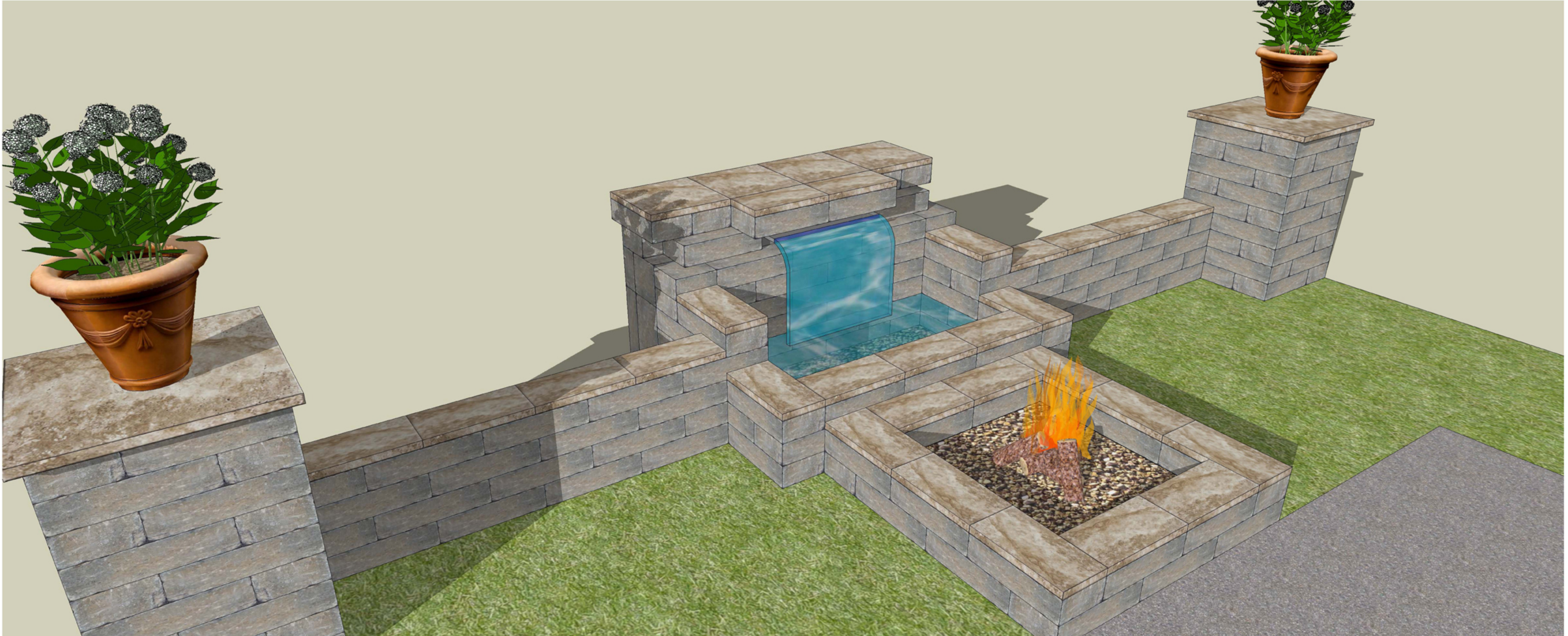

GeoStone Hardscape
 11321 Hwy 280 East
 Westover, AL 35185
 205-678-9969
 www.geostone.com

CLIENT
 Client Name
 12345 Main Street
 Boulder, CO 00000
 Tel: 000.000.0000

ISSUE
 08.08.08
 RE-ISSUE
 08.09.08

PROJECT NO.
 245.170
 PROJECT
 Project Name

DRAWN BY
 DJA
 DESCRIPTION
 Hardscape Rendering

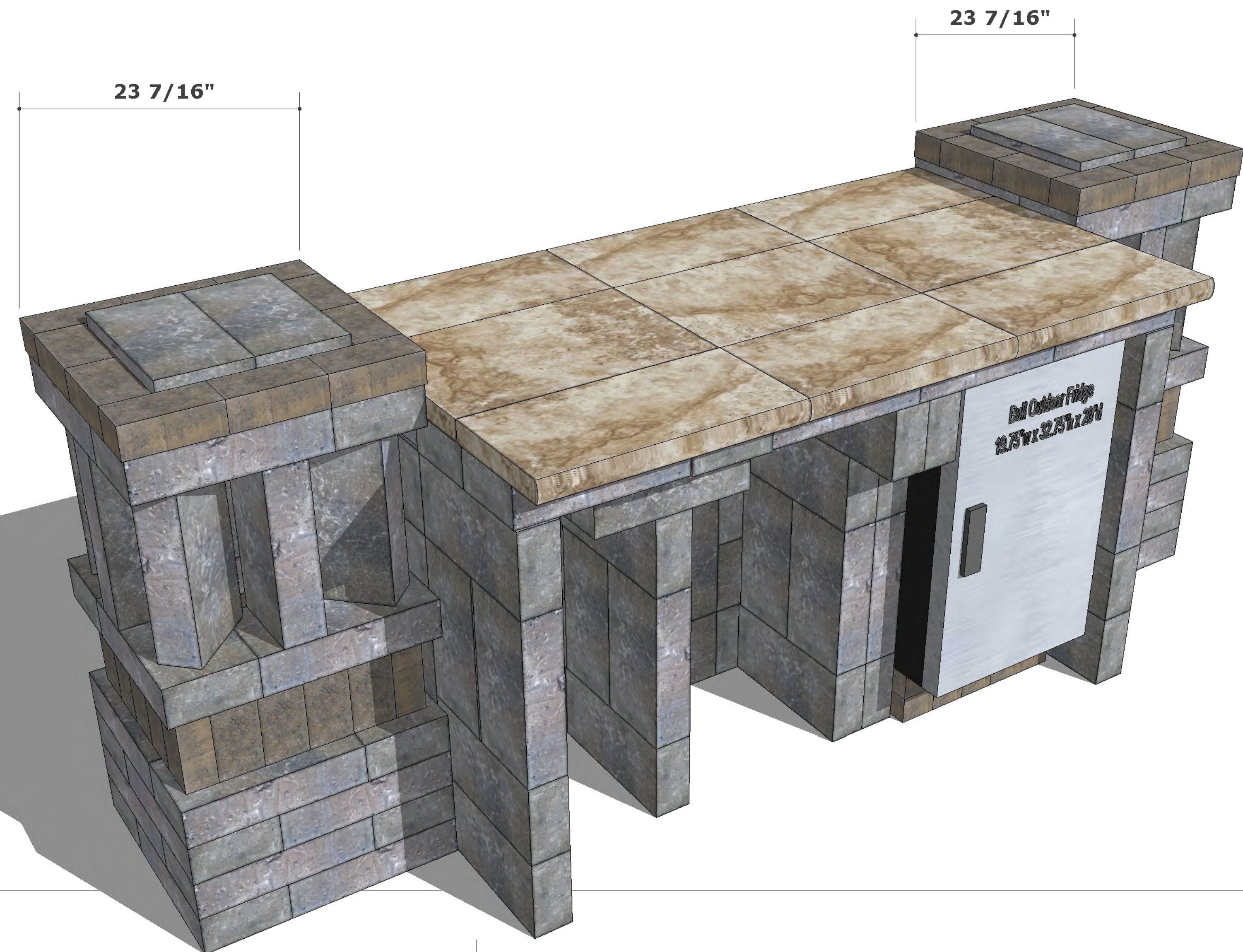

DAVID AGEE